

Household Hazardous Waste (HHW)

Household Hazardous Waste, or "HHW," is any leftover household product that contains corrosive, toxic, ignitable (flammable) or reactive ingredients. **Any product that contains one or more of these ingredients should NEVER be put into any of the curbside containers, down any drain, or on the ground.**

Examples of Household Hazardous Waste and other items that need to be disposed of properly:

Non-empty aerosol cans (recycle if empty)

Batteries

Brake fluid, coolant (antifreeze) and transmission fluid

Electronic waste (E-waste):

cell phones, calculators, computer monitors, computer towers and accessories, handheld electronics and games, printers, fax machines, telephones, televisions, and other electronics

Fertilizers

Medically-prescribed hypodermic needles or "Sharps"

Used motor oil and filters

Paint

Pesticides and fungicides

Plastic microwaves (metal ones can be recycled)

Universal waste (U-waste):

compact-fluorescent light bulbs (CFLs), fluorescent tubes, mercury-container thermometers and other items that contain mercury

Please turn to the next side for places that accept HHW, E-waste and U-waste.

In case of emergency, please call Poison Control at 1-800-222-1222 or dial 9-1-1.

Household Hazardous Waste (HHW)

Where to take Household Hazardous Waste (HHW), electronic waste (E-waste), and universal waste (U-Waste) for FREE:

Merced County, Division of Environmental Health's Drop off Areas:

1. Merced County HHW Facility accepts all HHW, E-waste and U-waste.

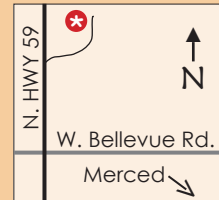

6040 N. State HWY 59 (its entrance is before the scale house), **Merced**
209-723-4753 or 209-381-1100
Mon, Wed, Fri:
9 AM - 3:30 PM,
Sat: 8 AM - 12 PM

2. Billy Wright Landfill accepts only: CFLs, E-waste

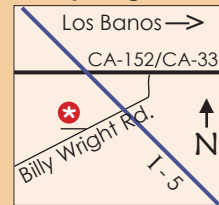

fluorescent tubes, car/truck batteries, household batteries, and used motor oil/filters.
17173 S. Billy Wright Rd,
Los Banos (drop off site to the right) 209-826-1163
Mon - Fri: 8 AM - 3:30 PM,
Sun: 8 AM - 12 PM

Not accepted:

Compressed gas cylinders, explosives, munitions, agricultural waste, medical waste, or radioactive materials.

For more information, please contact Merced County, Division of Environmental Health at 209-723-4753, 209-381-1100 or visit: www.mercedrecycles.com

Examples of items accepted at the Highway 59 Landfill (209-723-4481) and the Billy Wright Landfill (209-826-1163) - prices vary

Concrete

Large appliances

Mattresses/box springs

Tires

For information on landfill rates, hours and items accepted, please visit the County of Merced's website at www.co.merced.ca.us or MCAG's www.mercedrecycles.com/landfill.html



Images used in this publication are copyrighted ©. All rights reserved.